

G GROUND FLOOR PLAN (BLOCK-1)  
SCALE: 1:100

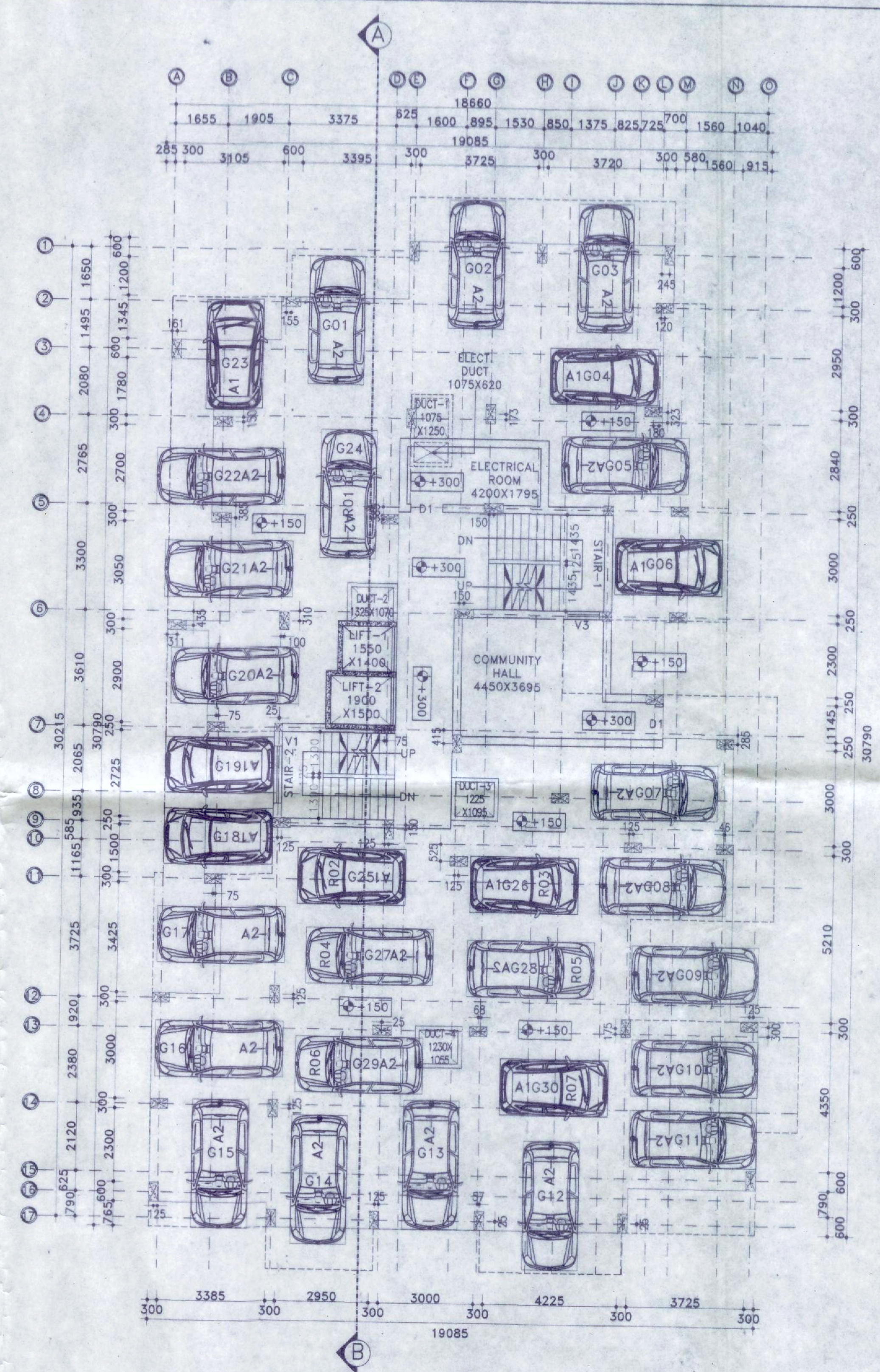

H GROUND FLOOR PLAN (BLOCK-2)  
SCALE: 1:100

**SCHEDULE OF DOOR & WINDOW:-**

MARK	SIZE	DESCRIPTION
D1	1000X2100	FULLY PNL
D2	900X2100	FULLY PNL
D3	750X2100	FULLY PNL
W	1800X1200	SLIDING WINDOW
W1	1500X1200	SLIDING WINDOW
W2	1000X1200	SLIDING WINDOW
W3	1250X1200	SLIDING WINDOW
V	600X450	UPVC MOVABLE VENTILATOR
V1		VENTILATION FOR STAIR CASE.

**PROJECT NAME:-**  
 PLAN OF PROPOSED (G+9) TEN STORIED RESIDENTIAL BUILDING OF (BLOCK-01 & BLOCK-02)  
 1) SRI. JIJWAL GHOSH, S/O - LATE SADHU CHARAN GHOSH, 2) SRI. UTTAM KUMAR GHOSH S/O LATE SADHU CHARAN GHOSH, 3) SRI. ANUP GHOSH S/O LATE SADHU CHARAN GHOSH, 4) SMT. MALATI LAHA W/O SRI SUNIL LAHA, 5) SMT. RINA GHOSH W/O SRI. MUKTI PADA GHOSH, 6) MR. KRIPAMOY MONDAL S/O LATE SRISTI DHAR MONDAL, 7) MR. SUBODH GHOSH S/O LATE SAMBHUNATH GHOSH, 8) MR. SANJIB KUMAR GHOSH S/O LATE SAMBHUNATH GHOSH, 9) SMT. DIPHA GHOSH DASTIDAR W/O MR. PARNESH GHOSH DASTIDAR. (DEVELOPED BY ASSUS REALCON & DEVELOPERS) AT J.L. NO-109, R.S. PLOT NO- 21, 22, 23, L.R. PLOT NO. - 39, 53, 54, 55 KHATIAN NO-1666, 2486, 2680, 2681, 2682, 2301, 2298, 2299, 2300, MOUZA-SHANKARPUR, P.S.- NEW TOWNSHIP.

- NOTES :-**
- ALL DIMENSIONS ARE IN M.M. AND ALL LEVEL ARE IN M.
  - WRITTEN DIMENSIONS MUST BE FOLLOWED
  - ALL EXTERNAL WALLS 250TH. & INTERNAL WALLS 125TH. UNLESS OTHERWISE MENTIONED.
  - ALL MASONRY WORKS ARE BOUNDED BY CEMENT MORTAR (1:6) & (1:4).
  - EXTERNAL PLASTER IS 25TH. & INTERNAL PLASTER IS 12MM.THK.
  - ALL CONC. GRADE IS M25 & AND GRADE OF STEEL FE-500
  - 250TH. BRICK WORK IN 1:6 MORTAR
  - 125TH. & 75TH. BRICK WORK IN 1:4 MORTAR
  - 150 WIDE SURFACE DRAIN SHOULD BE PROVIDED ALL ROUND THE BUILDING.
  - 25% OF THE BUILDING TO BE CONSTRUCTED USING FLY-ASH BRICKS

**AREA CALCULATION:-**

LAND AREA (SQ.M.)	PLINTH AREA	BLOCK - 1 (SQ.M.)		BLOCK - 2 (SQ.M.)	
		GROUND FLOOR	FIRST FLOOR	SECOND FLOOR	THIRD FLOOR
2074.42 (51.28 DECIMAL)	GROUND FLOOR	447.76	470.46		
	FIRST FLOOR	464.41	531.29		
	SECOND FLOOR	464.41	531.29		
	THIRD FLOOR	464.41	531.29		
	FORTH FLOOR	464.41	531.29		
	FIFTH FLOOR	464.41	531.29		
	SIXTH FLOOR	464.41	531.29		
	SEVENTH FLOOR	464.41	531.29		
	EIGHT FLOOR	464.41	531.29		
NINTH FLOOR	464.41	531.29			
TOTAL-	4627.45	5252.11			

GROUND COVERAGE AREA = 40.75 %  
 F.A.R = 2.24  
 NO. OF FLATS = 90  
 NO. OF CAR PARKING = 56

**TITLE:-**  
GROUND FLOOR PLAN (BLOCK-1 & BLOCK-2).

SIGNATURE OF STRUCTURAL ENGINEER:- <i>Hemant Ghosh</i> Hemant Ghosh Structural Engineer Lic. No. - L.B. 163/163/AMC-DMC/RD/165 Dist. - B-TECH, G.I.D.S., Durgapur-16 Contact No. - 933233331	SIGNATURE OF GEO-TECHNICAL ENGINEER:- <i>Manoj Maity</i> MANOJ MAITY Civil / Geotechnical Engineer CE, MGS - 1M4278 Lic. No. - LBP/162/AMC G.I.D.S., Durgapur - 16	SIGNATURE OF ARCHITECT:- <i>Hemant Ghosh</i> HEMANT GHOSH Consultant Civil Engineer - (Class-A) Lic. No. - L.B. 163/163/AMC-DMC/RD/165 Dist. - B-TECH, G.I.D.S., Durgapur-16 Contact No. - 933233331	SIGNATURE OF DEVELOPER/OWNER:- <i>Rina Ghosh, Kripamoy Mondal, Bipinash Dastidar, Anup Ghosh, Malati Laha</i> Rina Ghosh Kripamoy Mondal Bipinash Dastidar Anup Ghosh Malati Laha	CHECKED BY: H.GHOSH DATE : 26.02.2021 SCALE : 1:100. REV-00 SHEET NO:- GIDS/P&RD/ARCH-03/06
--	--	--	---	---

Approved Plan No. 27 on Meeting (1st) No. 12/2020-21, Date 08/12/2021, Valid upto 05/10/2023  
 Approved Plan No. 28 on Meeting (1st) to (4th) No. 13/2020-21, Date 08/12/2021, Valid upto 05/10/2023  
*Mallika Laha*  
Pradhan  
Jenua Gram Panchaya